

Male Connector

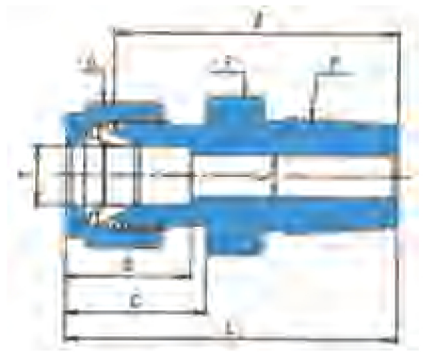

Fractional Range

Part No.	Tube O.D (T) inches	NPT (P*)	E Min	Width across flat		D	C	t	L
				F	G				
				inches	inches				
1MC1	1/16	1/16	1.27	5/16	5/16	8.63	10.92	20.02	23.83
1MC2	1/16	1/8	1.27	7/16	7/16	8.63	10.92	22.52	26.33
2MC2	1/8	1/8	2.28	7/16	7/16	12.70	15.24	23.88	30.48
2MC4	1/8	1/4	2.28	9/16	7/16	12.70	15.24	28.96	35.56
2MC6	1/8	3/8	2.28	11/16	7/16	12.70	15.24	29.21	35.81
2MC8	1/8	1/2	2.28	7/8	7/16	12.70	15.24	35.56	42.16
3MC2	3/16	1/8	3.04	7/16	1/2	13.71	16.00	24.63	31.24
3MC4	3/16	1/4	3.04	9/16	1/2	13.71	16.00	29.71	36.32
4MC2	1/4	1/8	4.82	1/2	9/16	15.24	17.78	25.40	32.76
4MC4	1/4	1/4	4.82	9/16	9/16	15.24	17.78	30.48	37.84
4MC6	1/4	3/8	4.82	11/16	9/16	15.24	17.78	30.99	38.35
4MC8	1/4	1/2	4.82	7/8	9/16	15.24	17.78	37.34	44.70
4MC12	1/4	3/4	4.82	1 1/16	9/16	15.24	17.78	38.86	46.22
5MC2	5/16	1/8	4.82	9/16	5/8	16.25	18.54	26.67	34.03
5MC4	5/16	1/4	6.35	9/16	5/8	16.25	18.54	31.24	38.60
5MC6	5/16	3/8	6.35	11/16	5/8	16.25	18.54	31.75	39.11
6MC2	3/8	1/8	4.82	5/8	11/16	16.76	19.30	27.94	35.30
6MC4	3/8	1/4	7.11	5/8	11/16	16.76	19.30	32.51	39.87
6MC6	3/8	3/8	7.11	11/16	11/16	16.76	19.30	32.51	39.87
6MC8	3/8	1/2	7.11	7/8	11/16	16.76	19.30	38.86	46.22
6MC12	3/8	3/4	7.11	1 1/16	11/16	16.76	19.30	40.39	47.75
8MC2	1/2	1/8	4.82	13/16	7/8	22.86	21.84	28.70	38.86
8MC4	1/2	1/4	7.11	13/16	7/8	22.86	21.84	33.27	43.43
8MC6	1/2	3/8	9.65	13/16	7/8	22.86	21.84	33.27	43.43
8MC8	1/2	1/2	10.41	7/8	7/8	22.86	21.84	38.86	49.02
8MC12	1/2	3/4	10.41	1 1/16	7/8	22.86	21.84	40.38	50.54
8MC16	1/2	1	10.41	1 3/8	7/8	22.86	21.84	46.99	57.15
10MC6	5/8	3/8	9.65	15/16	1	24.38	21.84	34.03	44.19
10MC8	5/8	1/2	11.93	15/16	1	24.38	21.84	38.86	49.02
10MC12	5/8	3/4	12.70	1 1/16	1	24.38	21.84	40.38	50.54
12MC8	3/4	1/2	11.93	1 1/16	1 1/8	24.38	21.84	40.38	50.54
12MC12	3/4	3/4	15.74	1 1/16	1 1/8	24.38	21.84	40.38	50.54
12MC16	3/4	1	15.74	1 3/8	1 1/8	24.38	21.84	46.99	57.15
14MC12	7/8	3/4	15.74	1 3/16	1 1/4	25.90	21.84	40.38	50.54
14MC16	7/8	1	18.28	1 3/8	1 1/4	25.90	21.84	46.99	57.15
16MC8	1	1/2	11.93	1 3/8	1 1/2	31.24	26.41	45.21	57.40
16MC12	1	3/4	15.74	1 3/8	1 1/2	31.24	26.41	45.21	57.40
16MC16	1	1	22.35	1 3/8	1 1/2	31.24	26.41	50.04	62.23